

APPROVED BY: _____
DATE: _____

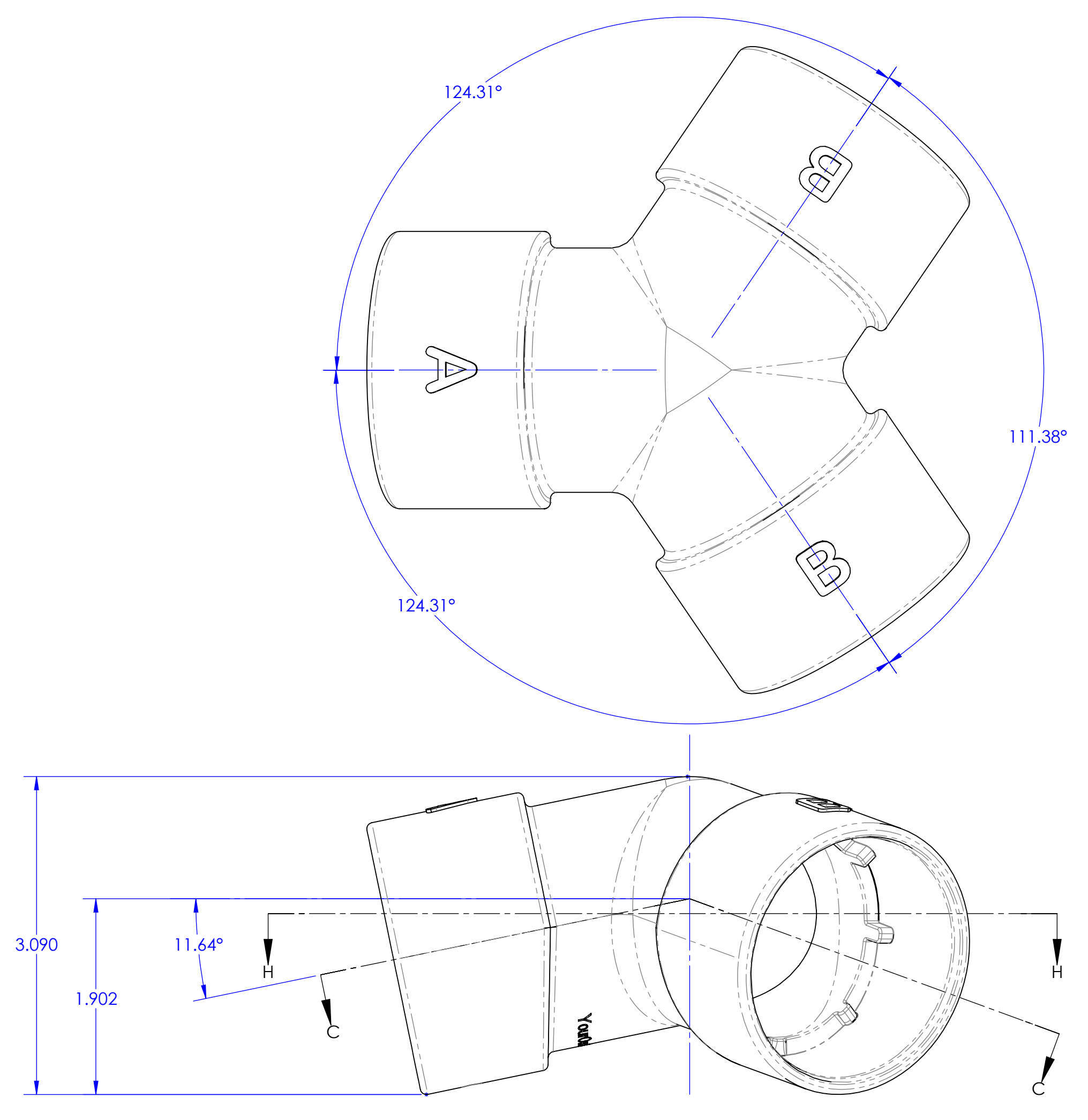

.35

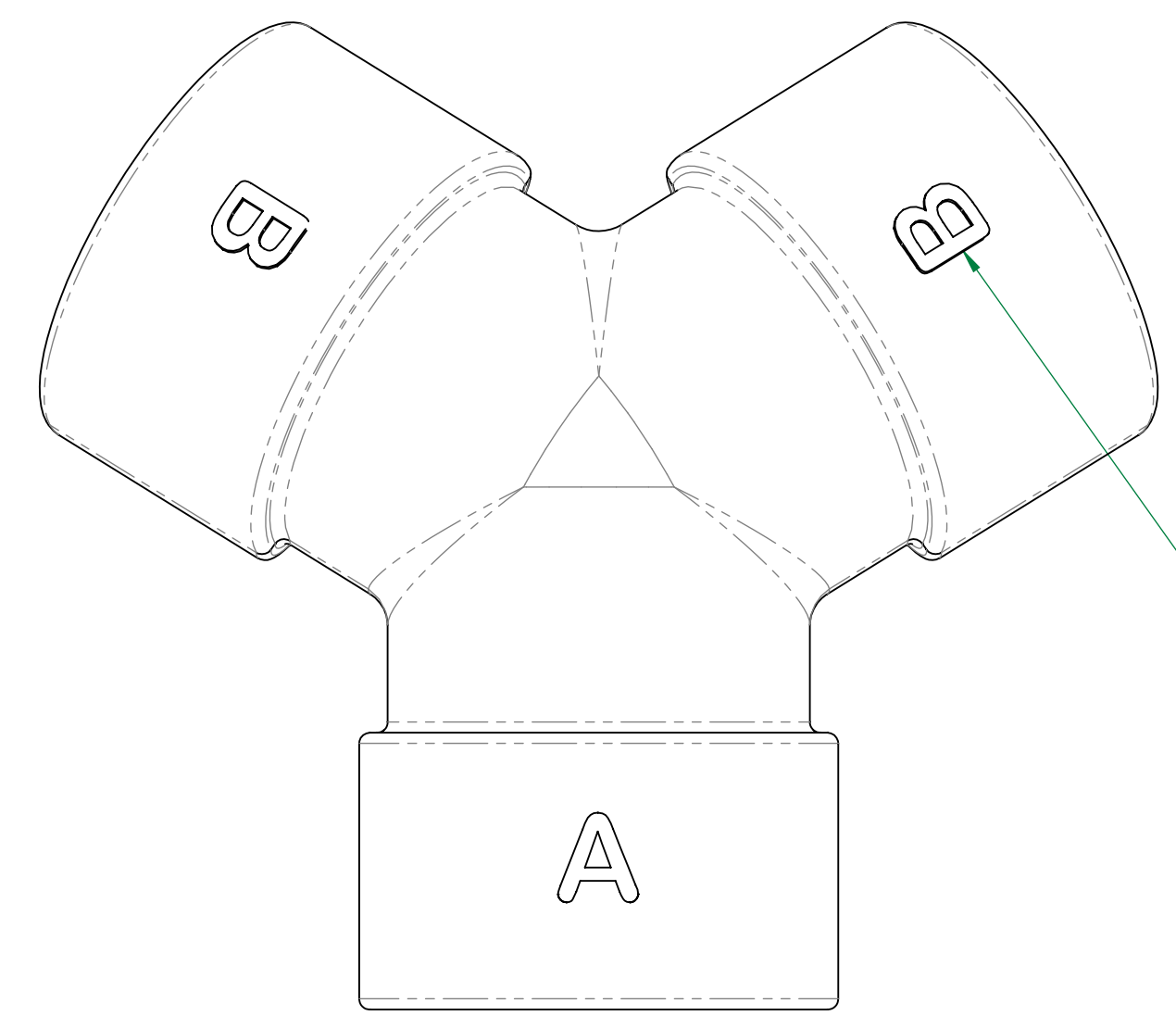
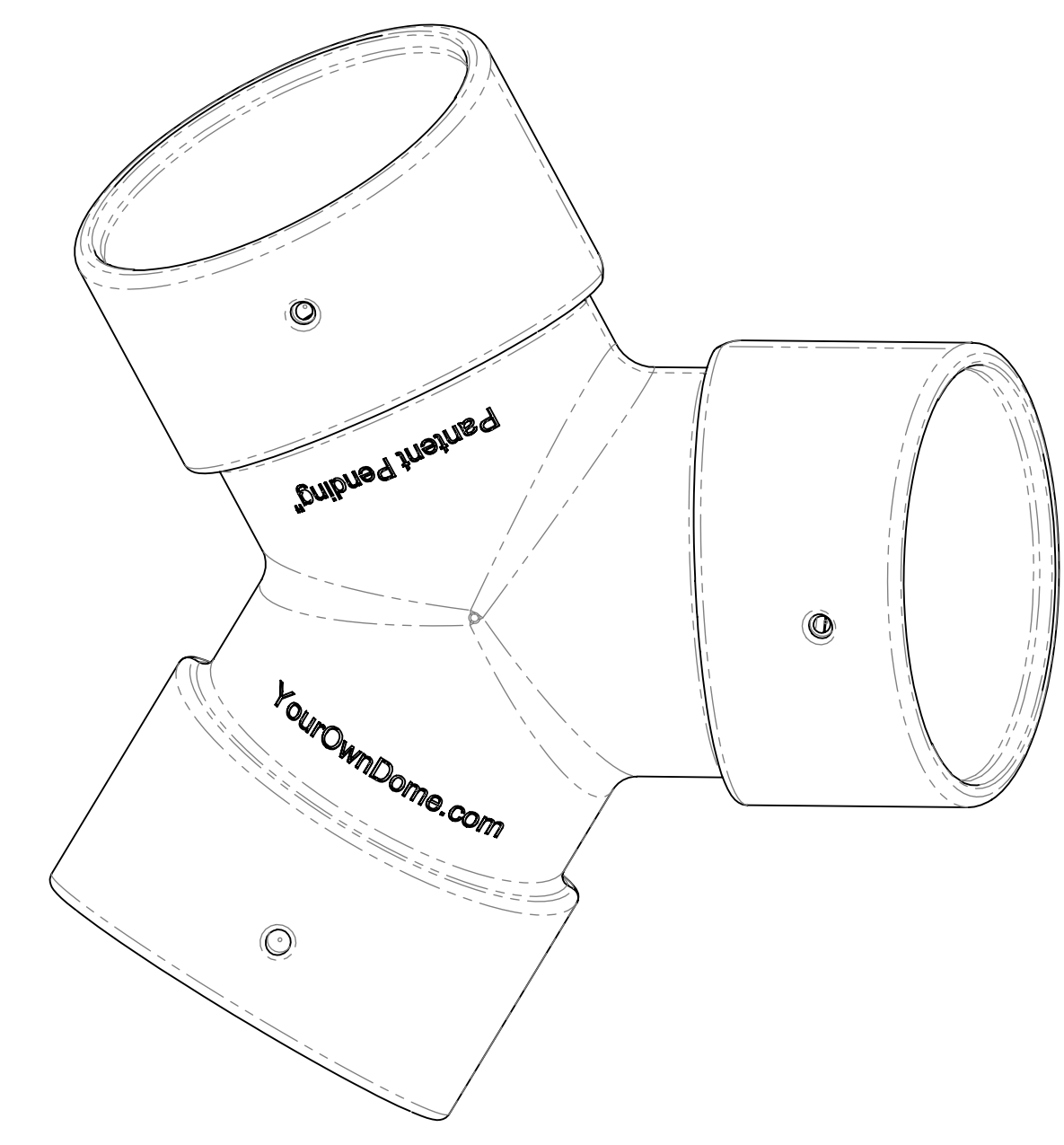
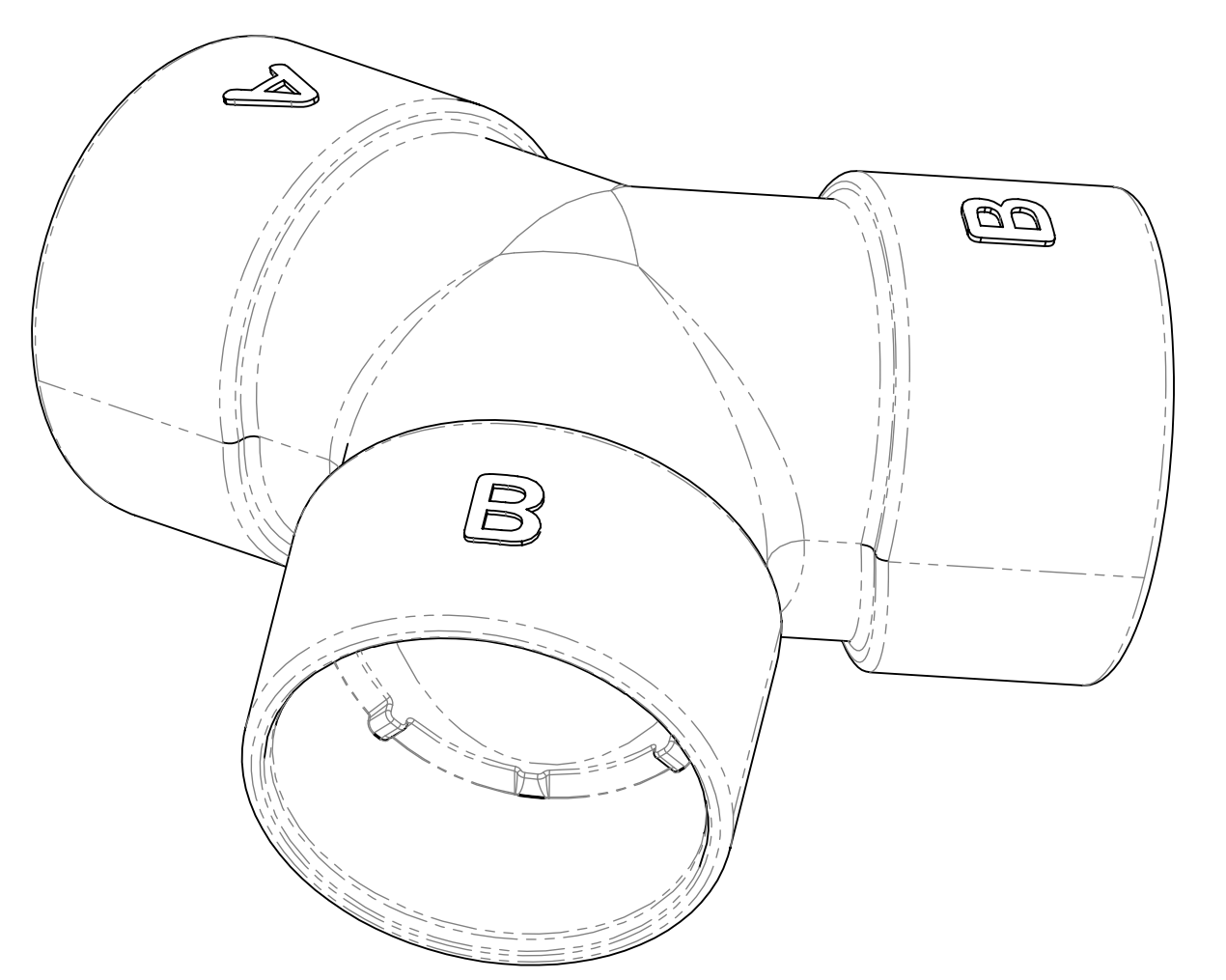

.50 LETTERING AS SHOWN, RAISED .030 (3X)

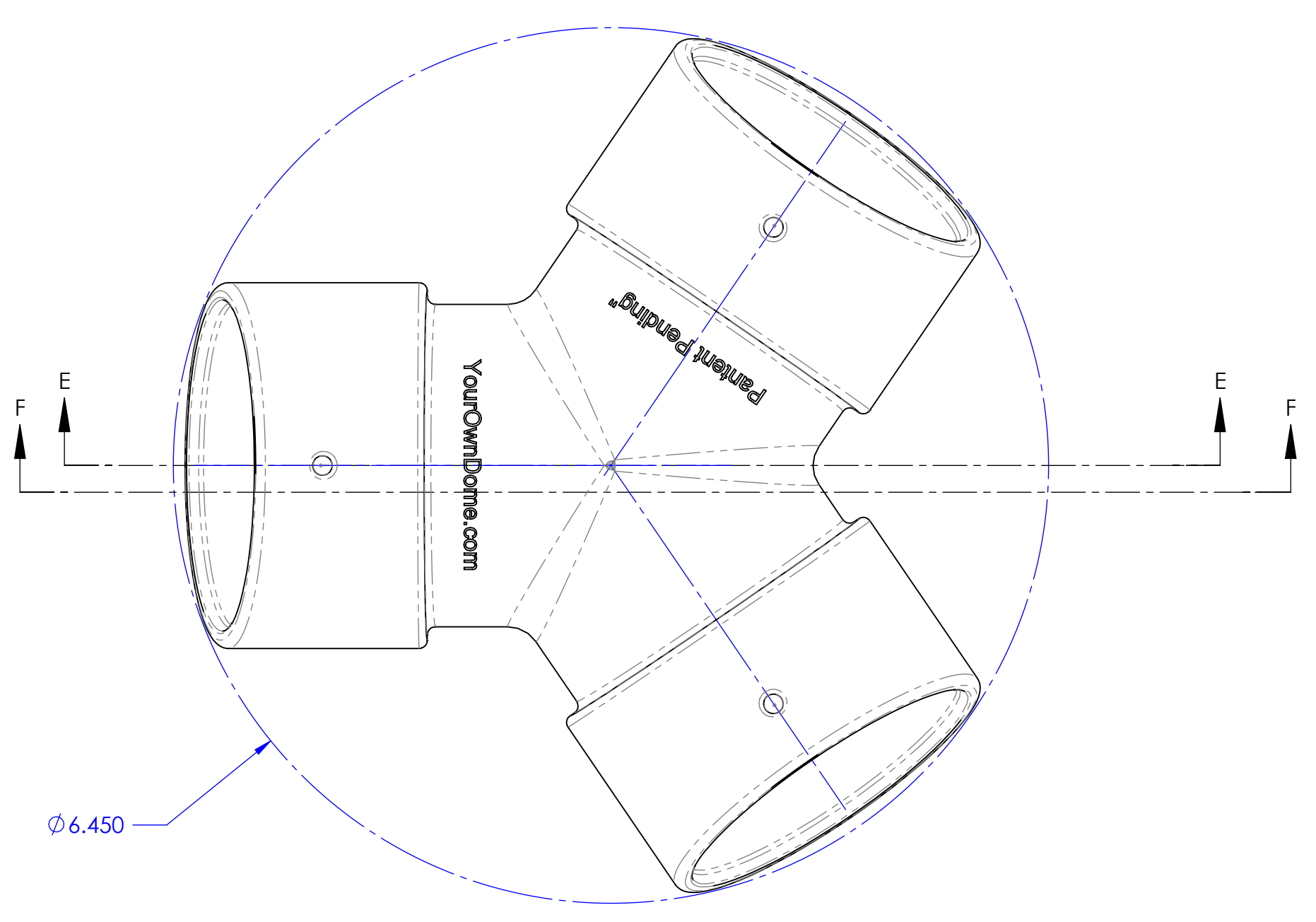

SHARP EDGES NOT PERMISSIBLE ON CONVEX EXTERIOR SURFACES (ABOVE FL)

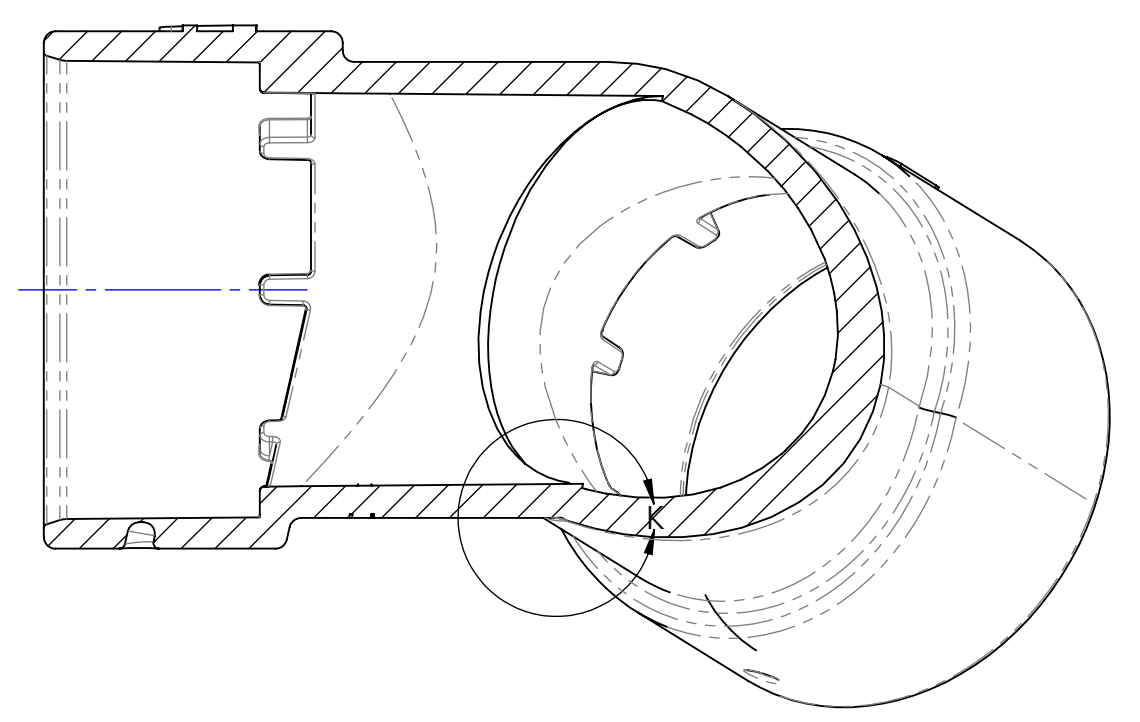
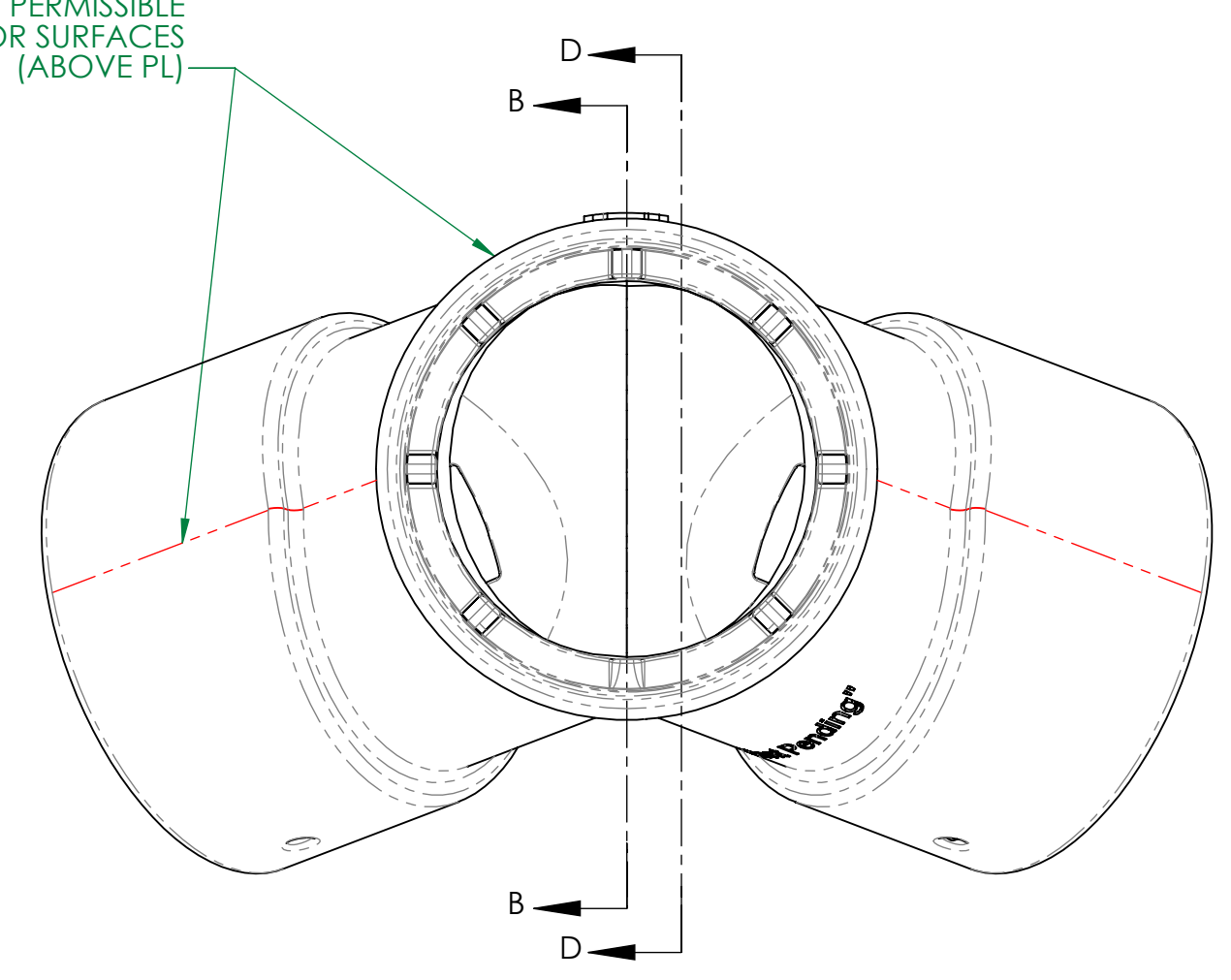

SECTION B-B

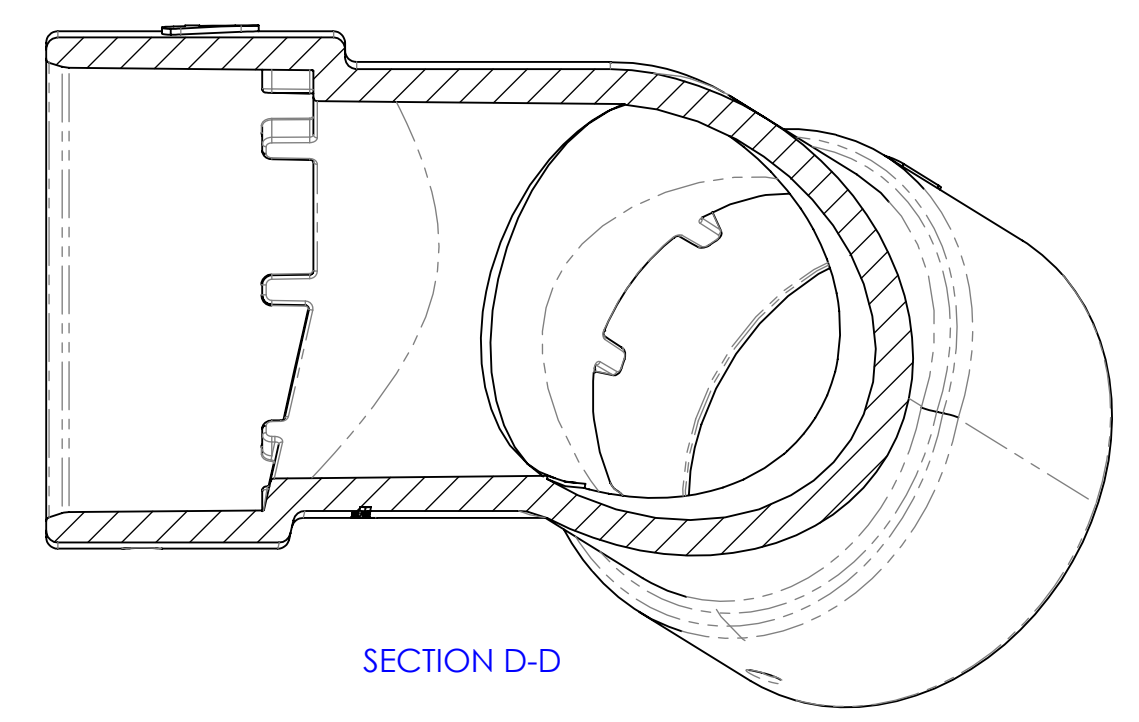

SECTION D-D

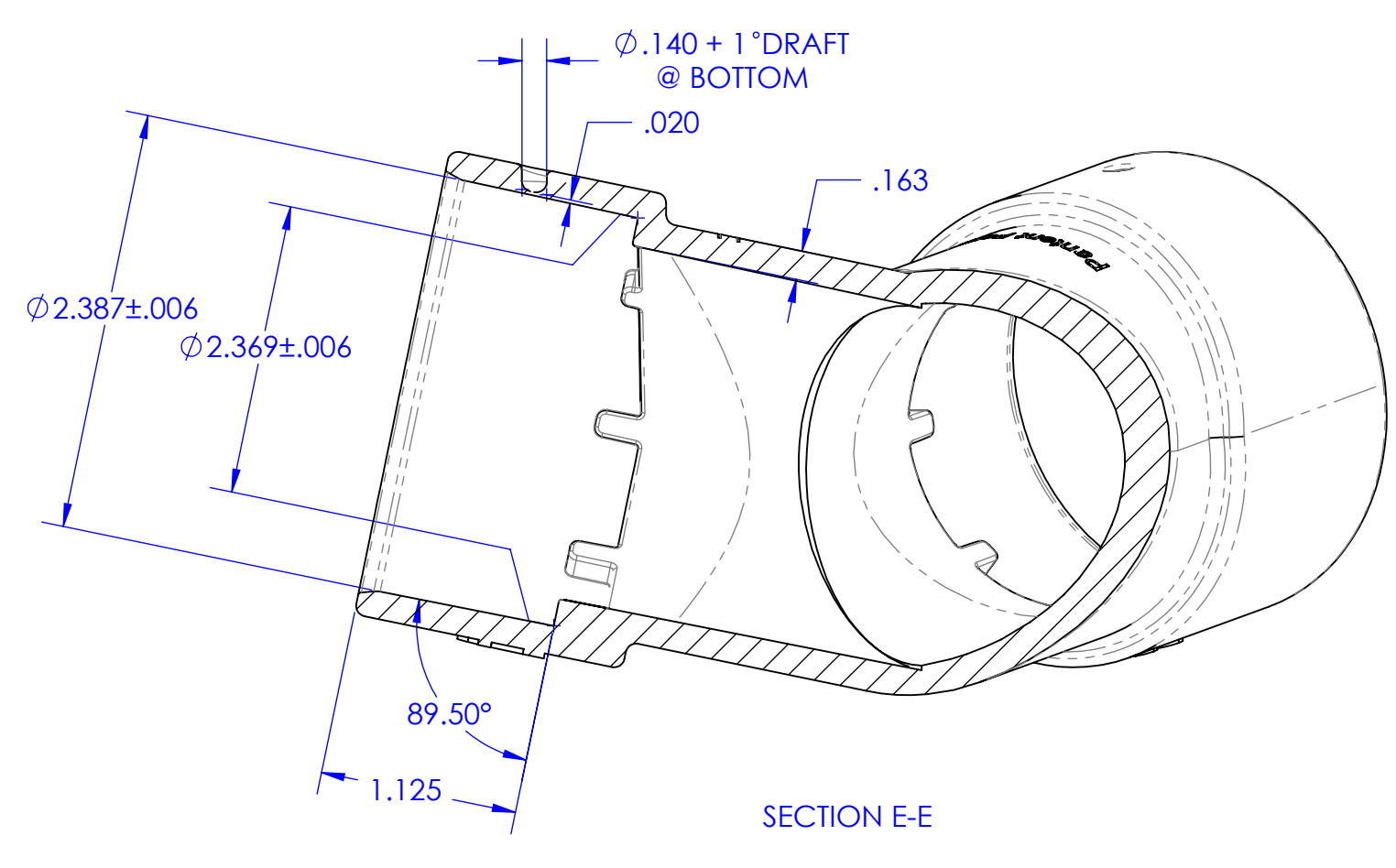

SECTION E-E

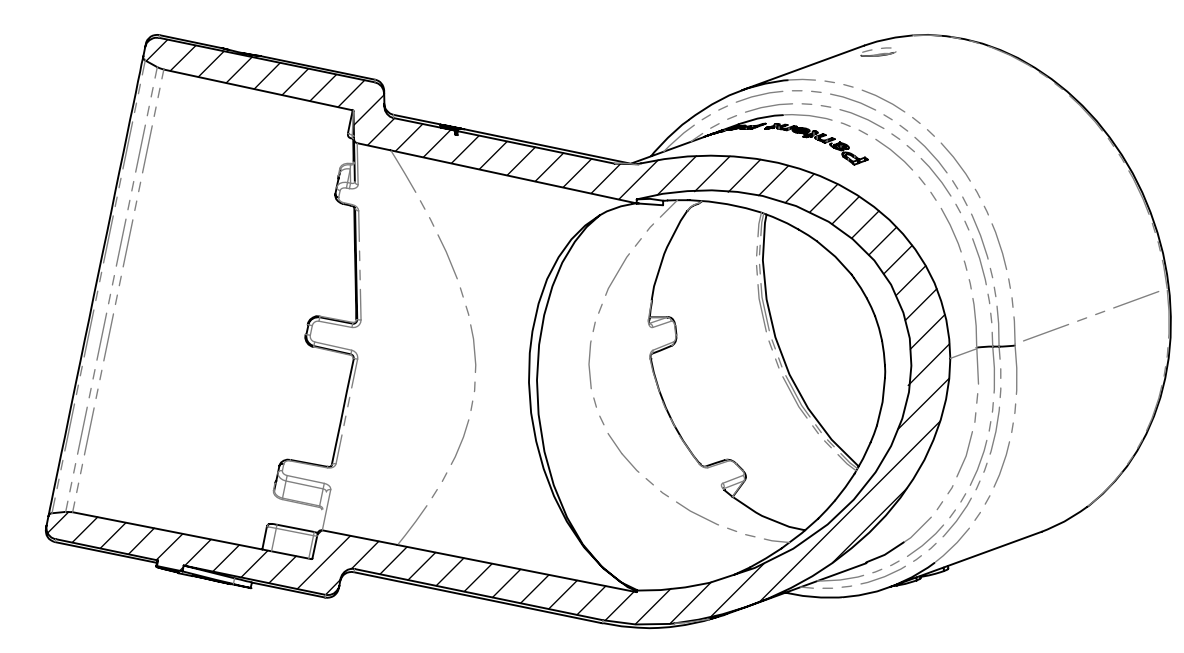

SECTION F-F

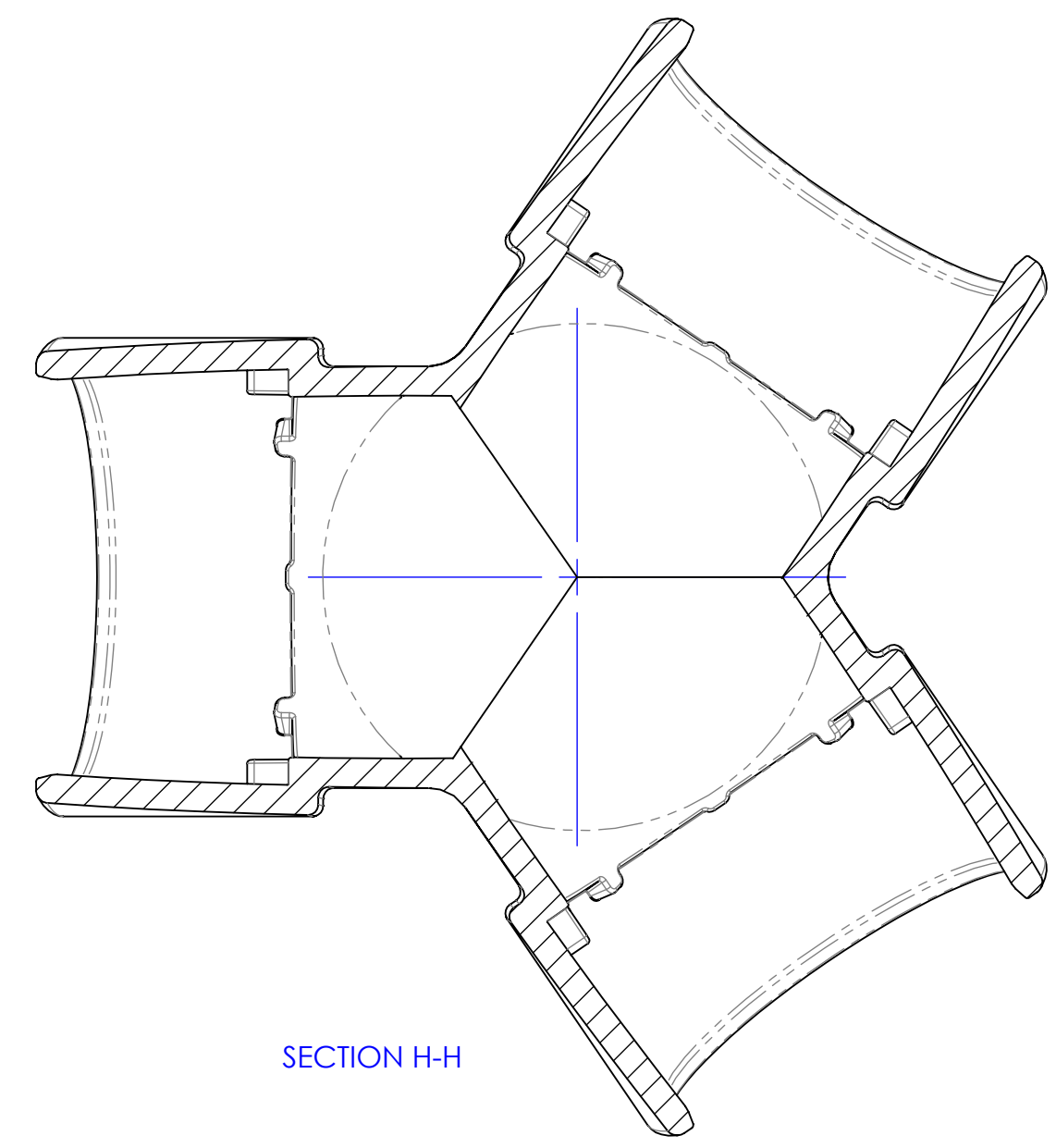

SECTION H-H

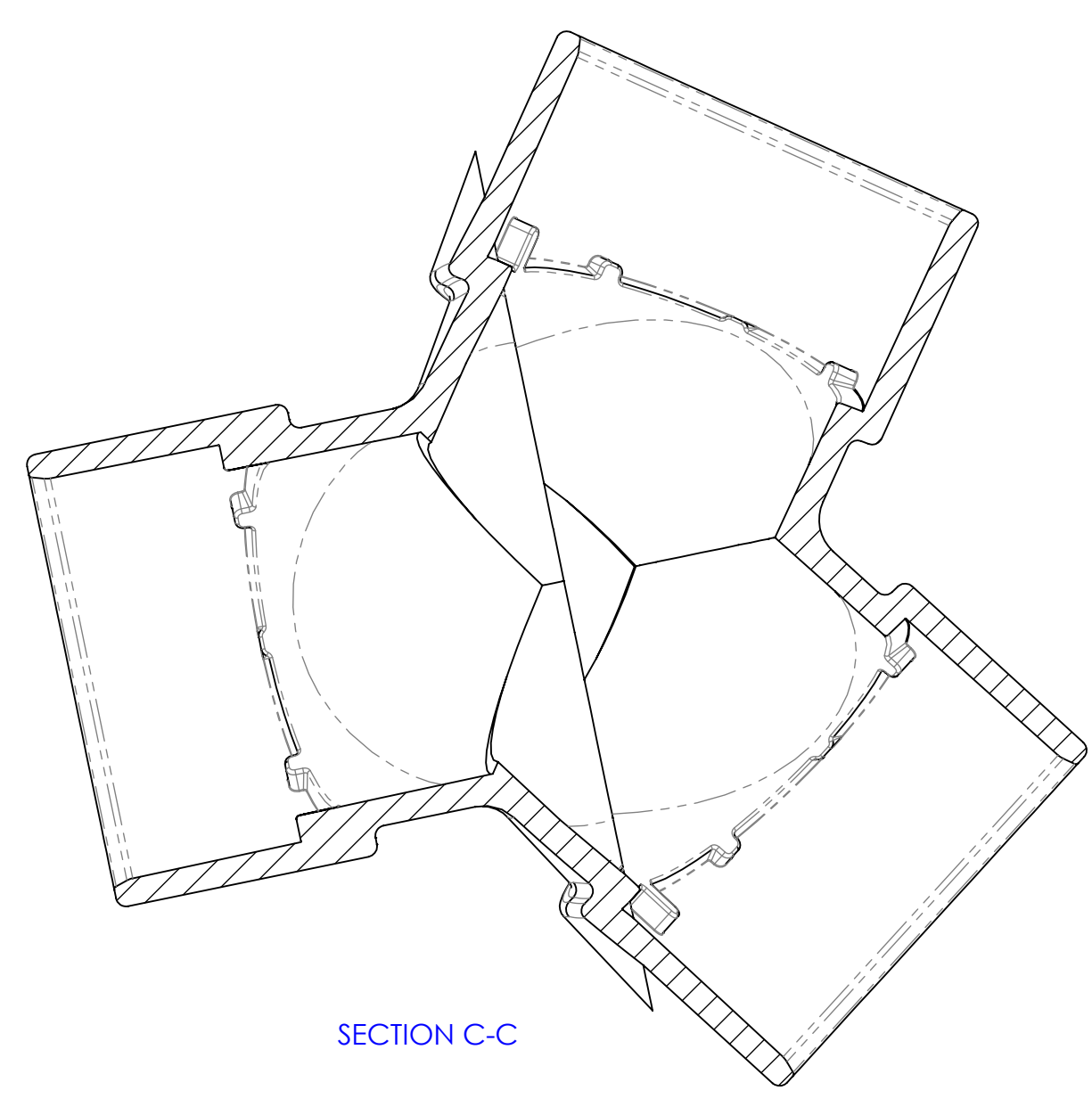

SECTION C-C

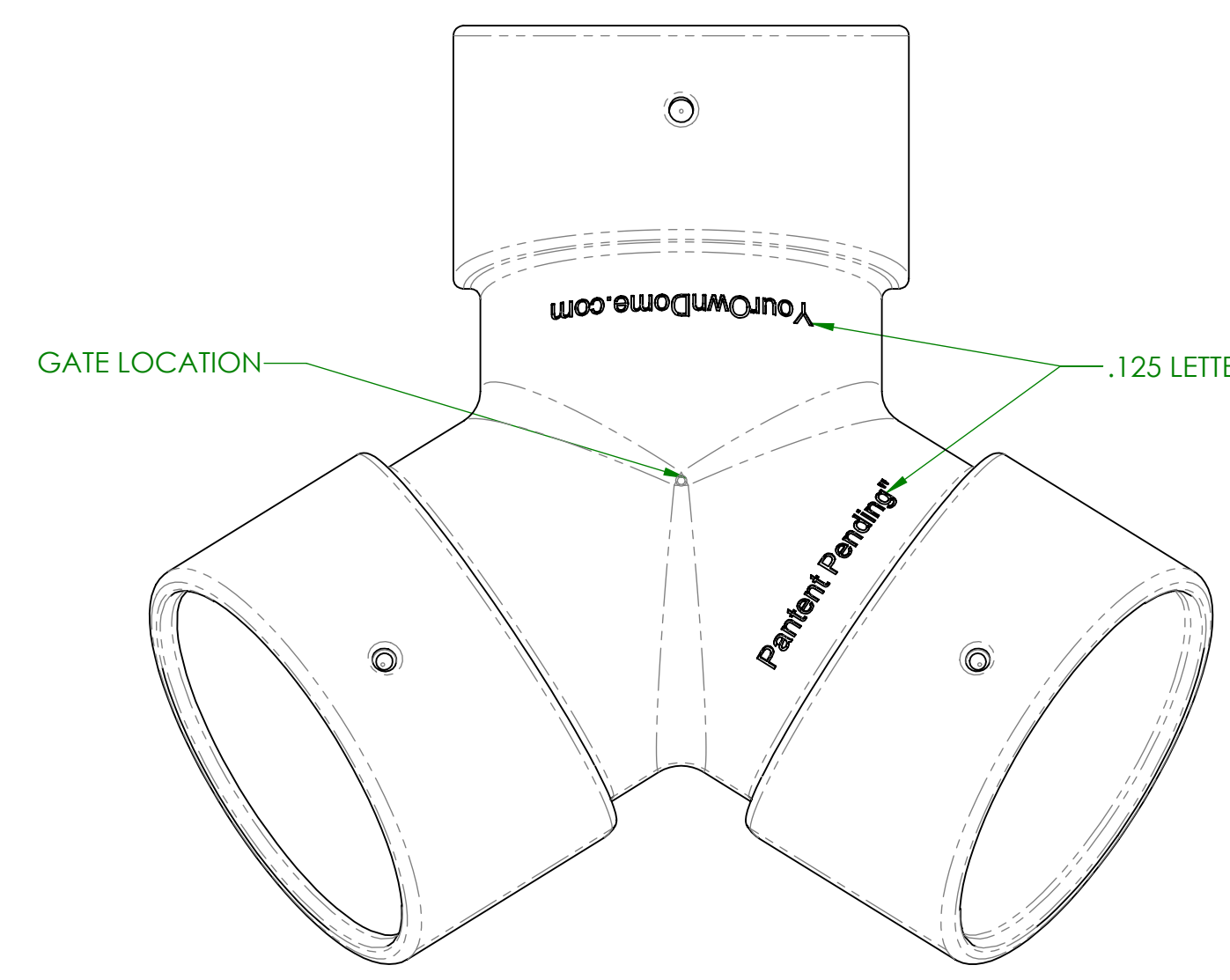

GATE LOCATION

.125 LETTERING AS SHOWN, RECESSED .020

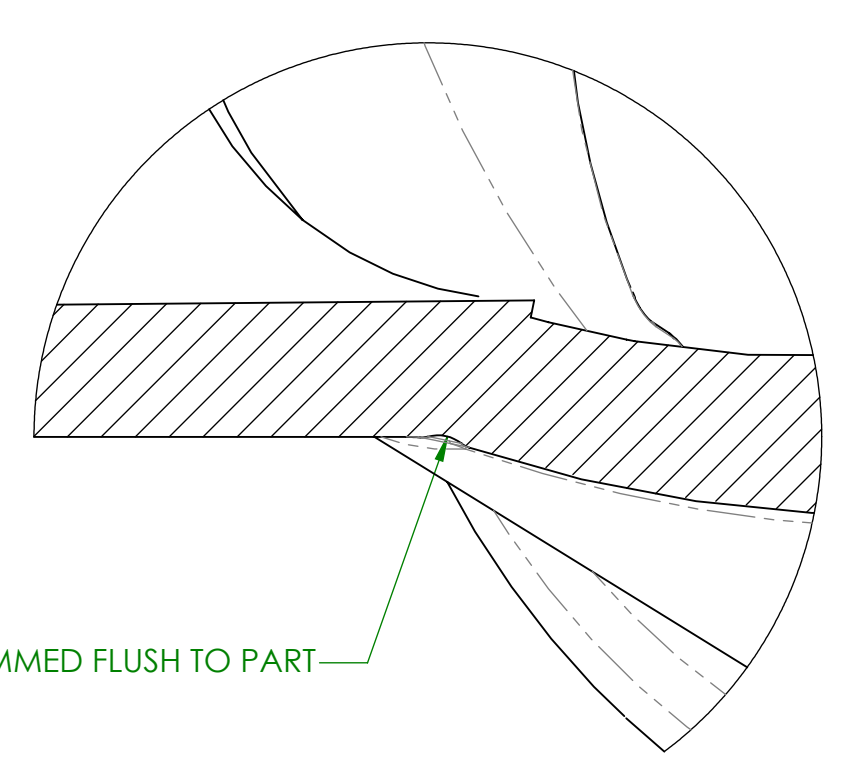

GATE MUST BE TRIMMED FLUSH TO PART

DETAIL K SCALE 4:1

- NOTES**
1. Manufacturing Process: Injection Molding
 2. Material: ABS
 - 2.1. Grade:
 - 2.2. SG:
 3. Color: Black
 4. Part Weight: xxx lbs. (x.xx) [Volume: x.x cu.cm.]
 5. Mold Shrinkage: x.xx
 6. Mold Finish: SPIR D-1 (Bead Blast)
 7. Molding Flash: Shall not exceed 0.010" on parting line and split lines
 8. Regulatory Requirements - Hazardous Materials: Supplier shall certify that parts comply with the following Hazardous Material Limitations:
 - 8.1. Phthalates: All US and EU regulations applicable to toys
 - 8.2. Lead Concentration: Less than 100 ppm
 - 8.3. RoHS

TOLERANCES		THERMOPRENE		NOTICE: CONFIDENTIAL PROPERTY	
ALL ANGLES 12°		ALL INFORMATION AND/OR DRAWINGS CONTAINED HEREIN ARE PROPRIETARY PROPERTY OF THERMOPRENE. REPRODUCTION OF THIS LETTER IN WHOLE OR PART IS FORBIDDEN WITHOUT THE EXPRESS WRITTEN CONSENT OF THERMOPRENE.		DATE	REV
LENGTH	TOLERANCES UNLESS OTHERWISE NOTED	SIZE: E	REVISION: 3	DATE: 11/15/10	REVISION
MATERIAL	DO NOT SCALE	SHEET: 1 / 1	SCALE: 1:1	BY: JMB	DATE: 1/12/11
ABS	LIMITS UNLESS OTHERWISE NOTED	SURFACE: xxx	DR'N: JMB	CUSTOMER: JMB	REV: 3
COLOR	FRACTIONAL: ±1.00%	EST. WT: xxx	CUSTOMER: JMB	CUST. P.N.: SEE DESC.	
BLACK	DECIMAL: ±0.005	FINISH: xxxx	DESCRIPTION: DOME COUPLING V4	DWG.#	
	ANGULAR: ±0.25°				